

BR7514~BR7516

Features

- Low forward voltage drop
- Insulation voltage: 2000V~

Application

- DC power supply
- Input rectifying of PWM converter
- Power supply of DC equipments

Characteristics

- Simple installation
- Smart size, Light weight
- Small heating resistance, high heat radiation, low temperature

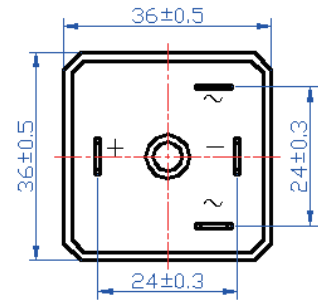
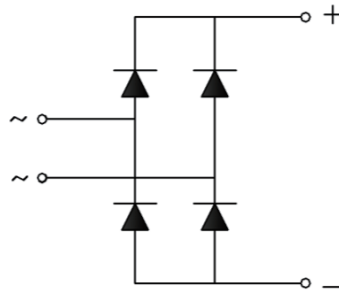
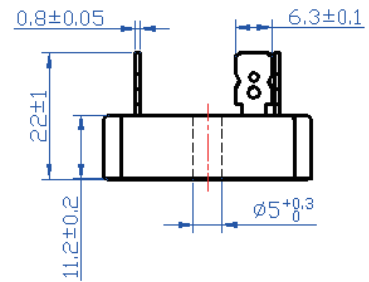
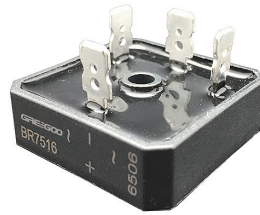

■ Max. value

Symbol	Rated		Unit
	BR7514	BR7516	
V_{RRM}	1400	1600	V
V_{RSM}	1500	1700	V

Symbol	Testing condition	Rated	Unit
$I_{F(AV)}$	180° sine anf half wave 50HZ, single side cooling $T_c=55^\circ\text{C}$	75	A
I_{FSM}	$t=10\text{ms}, 50\text{HZ}, \text{sin}, T_{jm}$	750	A
I^2t		2810	A^2S
V_{ISO}	50Hz, R.M.S, $t=1\text{min}$, $I_{iso}:1\text{mA}(\text{Max})$	2000	V
T_j		-40 to +150	$^\circ\text{C}$
T_{jm}		150	$^\circ\text{C}$
T_{stg}		-40 to +125	$^\circ\text{C}$
M_d		2	N·m
W_t		34	g

Symbol	Testing condition	Rated	Unit
I_{RRM}	$V_R=V_{RRM}$, sine anf half wave, $T_j=25^\circ\text{C}$	5	μA
	$V_R=V_{RRM}$, sine anf half wave, $T_j=150^\circ\text{C}$	3	mA
V_{FM}	$I_{FM}=17.5\text{A}$, $T_j=25^\circ\text{C}$	1.18	V
$R_{th(j-c)}$	single side cooling, sine anf half wave	1.1	$^\circ\text{C/W}$

BR7514~BR7516

Performance Curves

